

THIS SHEET IS INTENDED TO BE REPRODUCED AT 24"X36". ANY REPRODUCTION OF THIS SHEET AT A DIFFERENT SCALE SHALL VOID THE ORIGINAL SCALE SHOWN ON THE SHEET.

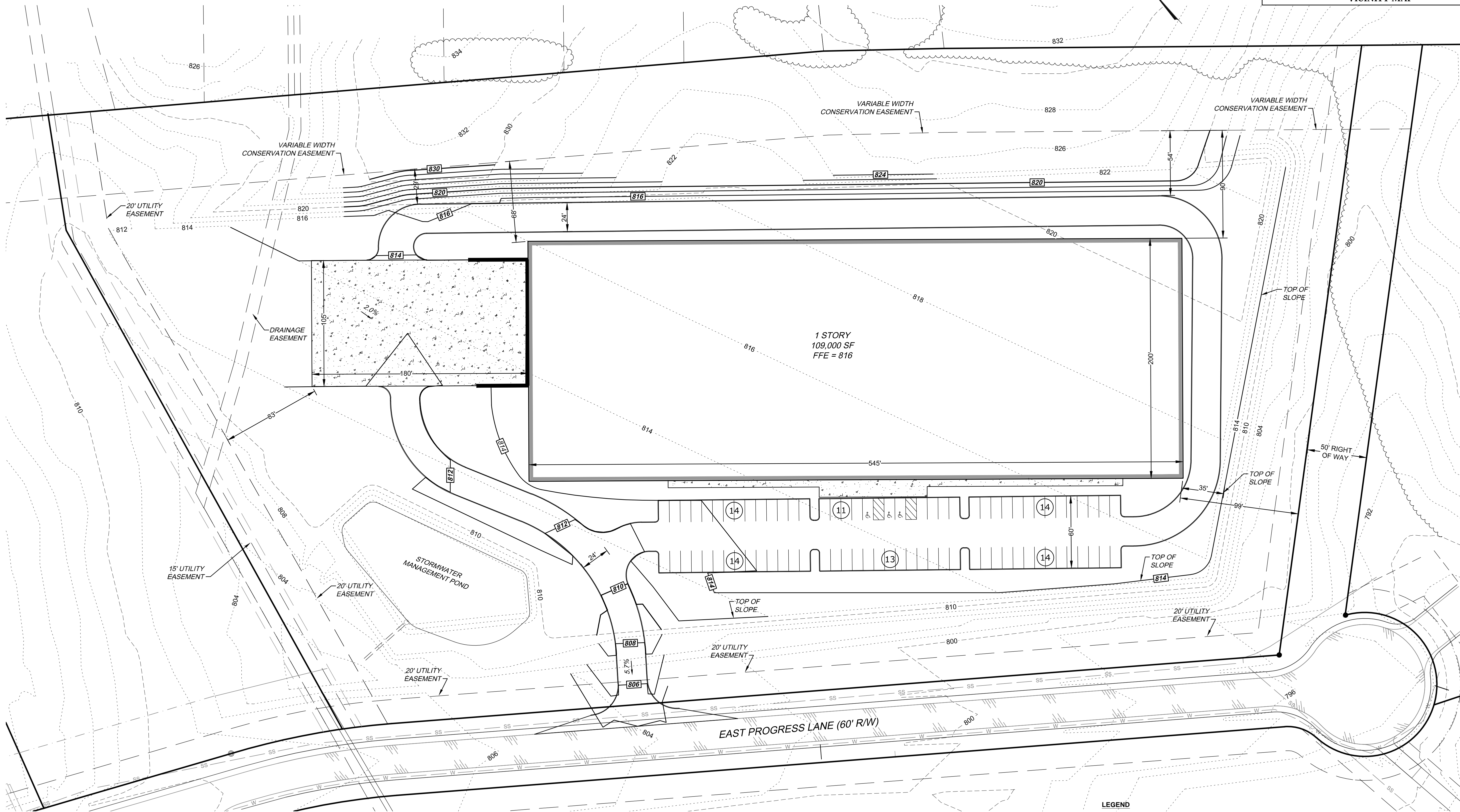

- LEGEND**
- 800 --- EXISTING INDEX CONTOUR
 - 810 --- PROPOSED INDEX CONTOUR
 - ==== CURB & GUTTER
 - ==== CONCRETE PAVEMENT
 - ==== PROPERTY LINE
 - EASEMENT

PRELIMINARY SITE NOTES:
 BUILDING AREA: 109,000 SF
 PARKING SPACES: 80 SPACES INC. 3 H/C SPACES
 EARTHWORKS: 10,000 CY (EXPORT 3,500CY)

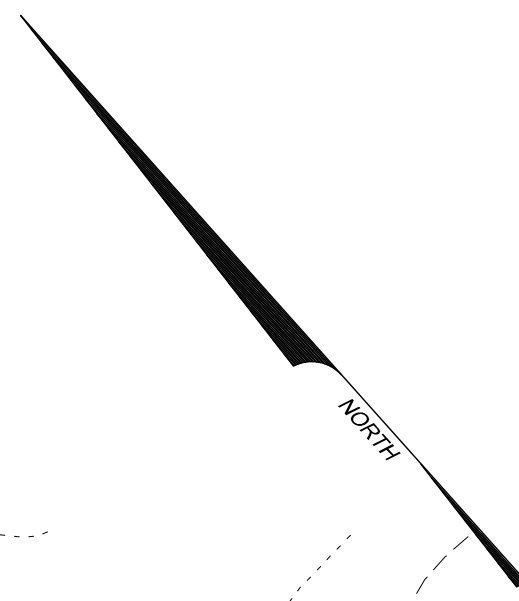
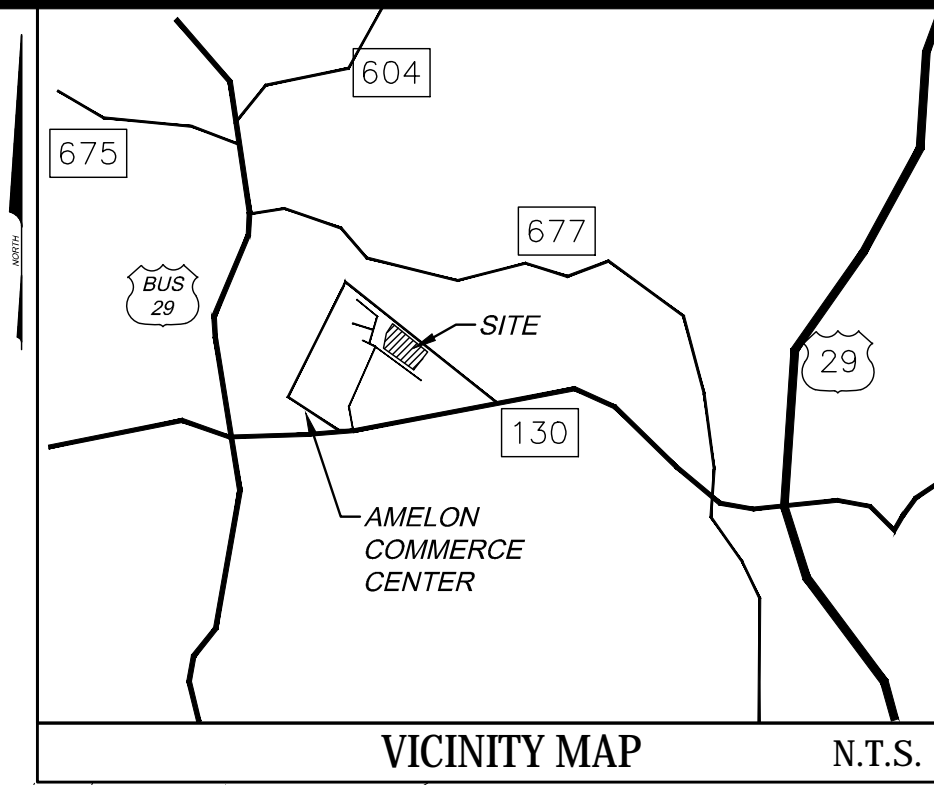

HURT & PROFFITT
 INSPIRED / RESPONSIVE / TRUSTED

434.847.7798
 2524 LANGHORNE ROAD
 LYNCHBURG, VA. 24501

LAND DEVELOPMENT
 SURVEYING
 GEOTECHNICAL
 CONSTRUCTION TESTING & INSPECTION • CULTURAL RESOURCES

LOT 6 - OPTION A
AMELTON COMMERCE CENTER
AMHERST ECONOMIC DEVELOPMENT AUTHORITY
AMHERST COUNTY, VIRGINIA

PROJECT NO.	20171946
LAT.	00.000000°
LONG.	-00.000000°
DATE:	01/23/2017
DRAWN BY:	RKW
CHECKED BY:	MDW

PRELIMINARY

0 20 40 80
 GRAPHIC SCALE IN FEET

HURT & PROFFITT

SHEET NO. 1 OF 1
 REV.

Mar 13, 2018 - 4:18pm I:\017\Projects\2017\1946\CD\Lot 6\Option A.dwg